

# Air Live<sup>®</sup>

[www.airlive.com](http://www.airlive.com)

## OV-1200SLC/20

*1000Base-SX/LX to 1000Base-SX/LX  
Fast Ethernet Media Converter*

### User's Manual



## **FCC Class B Certification**

This equipment has been tested and found to comply with the regulations for a Class B digital device, pursuant to Part 15 of the FCC Rules. These limits are designed to provide reasonable protection against harmful interference when the equipment is operated in a commercial environment. This equipment generates, uses, and can radiate radio frequency energy and, if not installed and used in accordance with this user's guide, may cause harmful interference to radio communications. Operation of this equipment in a residential area is likely to cause harmful interference, in which case the user will be required to correct the interference at his own expense.

## **CE Mark Warning**

This is a Class B product. In a domestic environment, this product may cause radio interference, in which case the user may be required to take adequate measures.

## **VCCI Class B Compliance (Japan)**

This is a product of VCCI Class B Compliance

この装置は、情報処理装置等電波障害自主規制協議会（VCCI）の基準に基づくクラス B 情報技術装置です。この装置は、家庭環境で使用することを目的としていますが、この装置がラジオやテレビジョン受信機に近接して使用されると、受信障害を引き起こすことがあります。

取扱説明書に従って正しい取り扱いをして下さい。



# Table of Contents

<b>INTRODUCTION .....</b>	<b>1</b>
<b>ABOUT MEDIA CONVERTER .....</b>	<b>1</b>
<b>PRODUCT FEATURES.....</b>	<b>1</b>
<b>INSTALLATION .....</b>	<b>1</b>
<b>SELECTING A SITE FOR THE EQUIPMENT .....</b>	<b>1</b>
CONNECTING TO POWER .....	2
INSTALLING IN A CHASSIS .....	2
<b>LED INDICATOR.....</b>	<b>3</b>
<b>SPECIFICATIONS.....</b>	<b>3</b>

## **Introduction**

Thank you for choosing the 1000Base Gigabit Ethernet Media Converter, The Converter introduced here provides one channel media conversion between 1000BASE-SX/LX .

## **About Media Converter**

The Media Converter is a network technology specified by IEEE 802.3 10BASE-T, IEEE802.3u 100BASE-TX, 100BASE-FX standards.

## **Product Features**

- One-channel media conversion between 1000BASE-SX/LX and 1000BASE-SX/LX.
- Fiber media allows: multi-mode fiber and single-mode fiber using SC connector
- Full wire-speed forwarding rate
- Front panel status LEDs
- Used as a stand-alone device or with a chassis
- Hot-swappable when used with a chassis

## **Installation**

This chapter gives step-by-step installation instructions for the Converter.

## **Selecting a Site for the Equipment**

As with any electric device, you should place the equipment where it will not be subjected to extreme temperatures, humidity, or electromagnetic interference. Specifically, the site you select should meet the following requirements:

1. The ambient temperature should be between 32 and 104 degrees Fahrenheit (0 to 40 degrees Celsius).
2. The relative humidity should be less than 90 percent, non-condensing.
3. Surrounding electrical devices should not exceed the electromagnetic field (RFC) standards for IEC 801-3, Level 2 (3V/M) field strength.
4. Make sure that the equipment receives adequate ventilation. Do not block the ventilation holes on each side of the switch or the fan exhaust port on the side or rear of the equipment.
5. The power outlet should be within 1.8 meters of the switch.

## Connecting to Power

1. This Converter is a plug-and-play device.
2. Connect the supplied AC to DC power adaptor with a power voltage of 7.5Vdc/1.5Amp to the DC-Jack on the converter, and then attach the plug into a standard AC outlet.

## Installing in a Chassis

The Converter can be fit into any of the expansion slots on a special designed chassis.

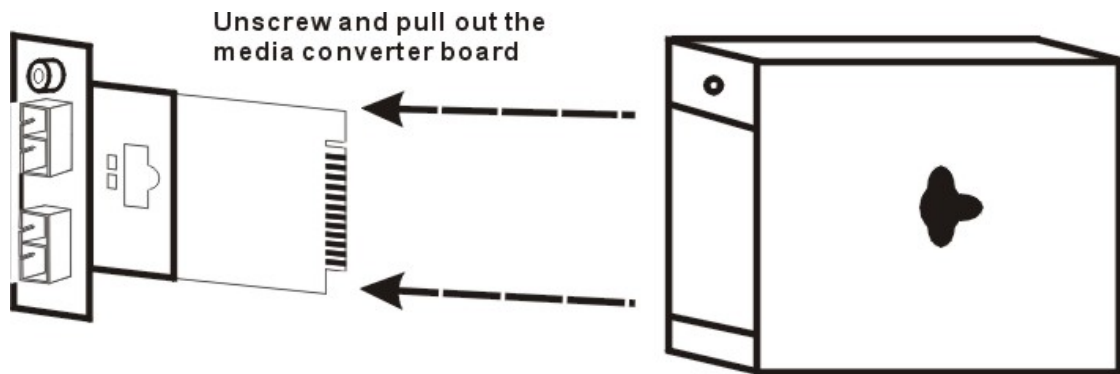

- First, install the converter onto a carrier supplied with the chassis:

Step 1- Unscrew and pull out the media converter board.

Step 2- Plug in the media board to any of the vacant slot.

Step 3- Fit the converter onto the carrier and use the screw to secure it.

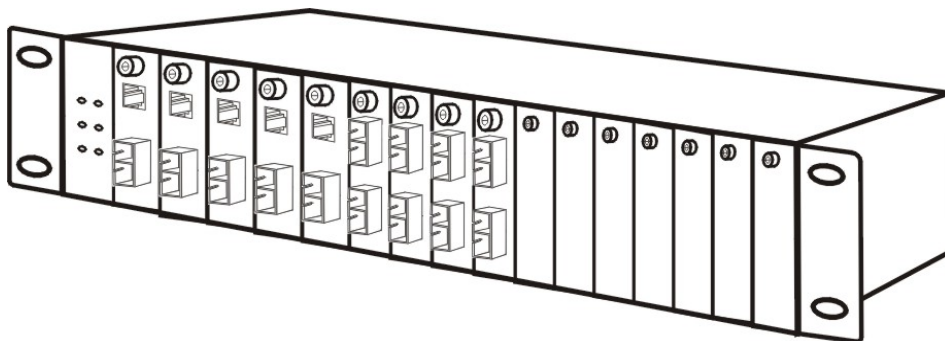

## **LED Indicator**

The LED indicators give you instant feedback on status of the converter:

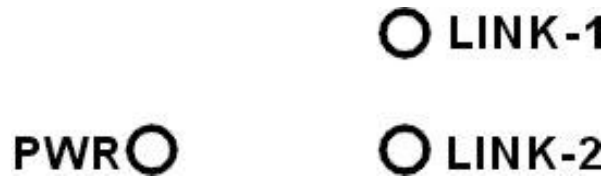

LEDs	State	Indication
Power (PWR)	Steady	Power on
	Lights off	Power off
LINK-1	Lights on	Linking on port FX-1
	Lights off	Not Linking
LINK-2	Lights on	Linking on port FX-2
	Lights off	Not Linking

## **Specifications**

Standards: IEEE802.3z 1000BASE-SX/LX  
Data Transfer Rate: 1488000pps for 1000Mbps  
Duplex Mode: Full Duplex Mode  
LED indicators: PWR, LINK-1, LINK-2  
Media Interface: SC  
EMI Compatibility: FCC Class B  
CE Certification, Class B  
VCCI Class B  
Temperature: Storage: -10°C ~ 70°C  
Operating: 0°C ~ 40°C  
Humidity: 10% ~90% non-condensing  
Power Consumption: 7.2 Watts (maximum)